



EXPLANATION OF THE TEST

Feline coronavirus (FCoV) is a highly contagious intestinal infection that causes few problems in most infected cats. In some cats, however, the intestinal form of FCoV mutates and gives rise to feline infectious peritonitis (FIP), a disease that is generally fatal. It is estimated that up to 70% of cats, worldwide, are exposed to Feline Coronaviruses (FCoV).

Asan Easy Test[®] FCoV Ab is a chromatographic immunoassay kit for rapid and qualitative detection of feline corona virus antibody in feline serum, plasma or whole blood.

MATERIALS PROVIDED

Asan Easy Test[®] FCoV Ab contains following components :

1. Test devices individually foil-pouched with a desiccant : 10 units
2. Assay solution in tube (1ml/vial) : 10 units
3. EDTA tube : 10 units
4. Disposable dropper : 10 units
5. 5 μ l capillary tube (for serum or plasma) : 10units
6. 10 μ l capillary tube (for whole blood) : 10units
7. Instruction manual for use : 1 sheet

PRECAUTIONS

1. The presence of humidity may decrease the stability of the reagents. Thus, please carry out the test immediately after removing the device from the foil pouch.
2. Do not use the kit after the expiration date and do not freeze the kit.
3. For veterinary use only.
4. Wear protective gloves while handling samples and wash hands thoroughly after the test.
5. Dispose all the specimens and kits properly after test, in accordance with GLP.
6. Never use reagent from another kits and do not reuse the test kit.
7. Discard the assay solution if it is contaminated with bacteria or mold.

SPECIMEN COLLECTION AND STORAGE

1. Specimen to be tested should be obtained and handled by standard methods for their collections.
 - A. Serum: Allow the blood to clot, then centrifuge to separate the serum.
 - B. Plasma: Collect the whole blood into the tube contained anticoagulants such as heparin, citrate, or EDTA. Centrifuge the blood and separate the plasma.
 - C. Whole blood: Collect an anticoagulated blood sample in EDTA, heparin or citrate using standard clinical laboratory procedures. Anti-coagulated whole blood samples should be tested within 24 hours of drawing. If delays are expected between sampling and testing, the sample should be stored refrigerated (2~8 $^{\circ}$ C), but should not be frozen.
2. Serum and plasma should be tested as soon as they are prepared. If necessary, they may be stored at 2~8 $^{\circ}$ C for up to 24 hours or at -20 $^{\circ}$ C for longer periods.

TEST PROCEDURE

1. Place all specimens, test devices, and allow them to room temperature prior to testing (15~30min).
2. Remove the test device from the sealed pouch, and place it on a clean and plain place.
3. Using the capillary tube in the kit, add 10 μ l of whole blood (5 μ l of serum or plasma) sample into the assay solution tube.
4. Gently stir the mixture solution with the capillary tube to make sure the suitable mixing of specimen with diluent buffer, and then remove the capillary tube.
5. Using the disposable dropper provided in the kit, take the mixture solution from the tube. And then, add 3 drops of the mixture solution into the test device.
6. Interpret the test results at 10 minutes. Do not interpret after 15 minutes.

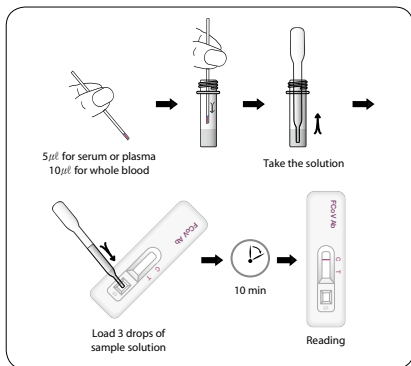

INTERPRETATION OF THE TEST

1. Negative result : ONLY one band in the control line (C).
2. Positive result : Two band appear in the test line (T) and control line (C).
3. Invalid result : If at 10 minutes, the red color band does not appear in the control line (C), even if any shade of a pink-to-red test line (T) appear, the result is considered invalid. If the test is invalid, a new test should be performed with a new sample and a new test device.

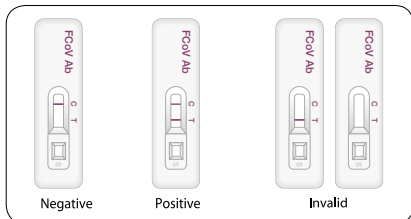

STORAGE & EXPIRATION

1. Asan Easy Test[®] FCoV Ab should be stored between 1 to 30 $^{\circ}$ C (33.8~86 $^{\circ}$ F).
2. Expiration date of this kit is 24 months after its manufacture date.

LIMITATIONS OF THE TEST

Asan Easy Test[®] FCoV Ab is designed for primary screening test of antibodies against feline corona virus in the feline serum, plasma or whole blood. This kit can provide fast and easy way to get a result, but do not completely exclude the possibility of false positive or false negative result caused by various factors. So, refer to the result of this kit, please make a final decision with clinical manifestation, other test results, and veterinarian's view, collectively.